

Dual Liquid Swabs for Emergency MRSA Screening



1 Open peel pouch.



2 Remove liquid tube and uncap.



3 Remove pink swab and moisten with sterile saline.

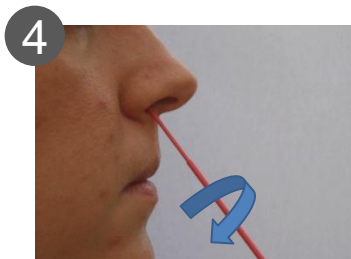

4 Swab inside patient's nostril, rotating and pressing lightly against inside of nose. Repeat in second nostril with same swab.



5 Put pink swab into liquid. Rotate swab against side of tube to release sample into liquid then **remove and discard pink swab**. Re-cap the tube.



6 Remove white swab and moisten using sterile saline.



7 Swab groin by rubbing against skin and rotating.



8 Un-cap liquid tube. Put white swab into the same tube and break swab shaft off at the pre-moulded breakpoint.



9 Re-cap the tube containing the white swab. Label clearly with two patient identifiers.

Label all MRSA screening sample forms with "MRSA SCREENING"

- Do not send dry swabs. The liquid in the tubes keeps the bacteria alive.
- If you spill the liquid before inserting a swab, use a new tube from a new pouch.
- If you spill the liquid after you have inserted a swab, you will need to start again.
- If you need an M,C&S test, please send an additional single liquid swab.

Take additional MRSA screening samples if:

- If the patient has a skin **lesion** – take a **SINGLE** swab from the lesion.
- If the patient has a **urinary catheter** – collect a CSU for MRSA screening.